

Welcome

Welcome to Microsoft's public exhibition for a new datacentre development at our site located in Eggborough.

Microsoft intends to submit a planning application after consulting with the local community.

After viewing the proposals, please let us know your thoughts and feedback.

We would be delighted to answer any questions you may have.



Datacentres are the infrastructure that delivers the cloud

The cloud plays a significant role in our everyday lives, enabling remote work and learning, global collaboration, supporting discovery and innovation, and importantly, powering critical life and safety services.

Datacentres have become integral to our lives, with social media, contactless payments and remote working all reliant on the functionality they provide, the UK needs more new datacentres to power the economy of the future.

Organisations in the United Kingdom rely on the Microsoft Cloud, including companies large and small, startups, governments, hospitals, banks, schools, and more.

Datacentres power our digital world

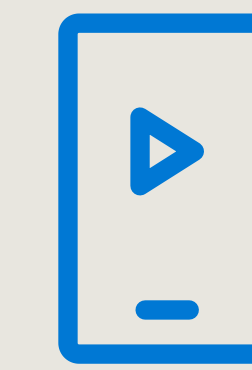

Streaming videos

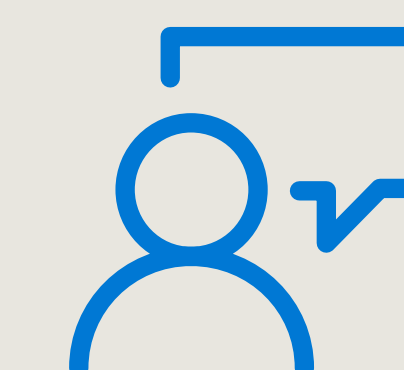

Collaboration



Email



Online banking



File storage



Online shopping

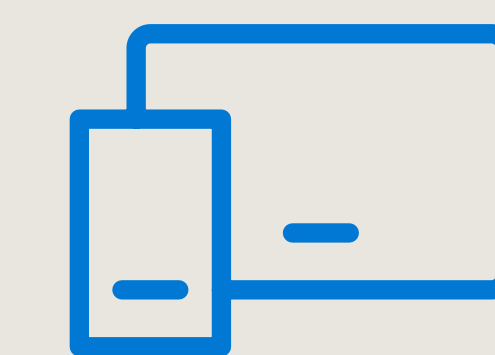

Mobile apps

Who uses the Cloud

The Microsoft cloud serves over 1 billion customers and over 20 million companies worldwide.

Over 95% of Fortune 500 companies run Microsoft Azure.

Many of the UK's top companies and public sector agencies use the Microsoft Cloud to modernise and digitise their operations.

Government and education



Banking and financial services



Manufacturing

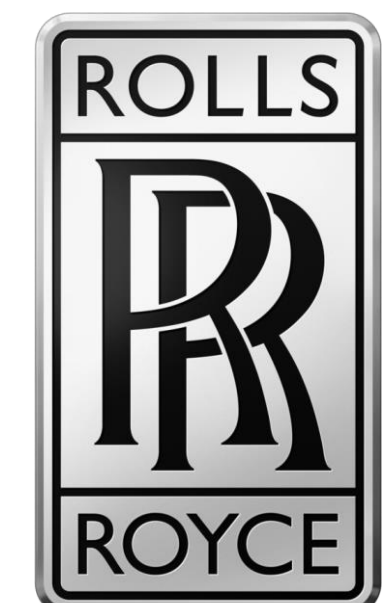

Travel and Transportation



Retail



Automotive



About the site

The site has been a vacant brownfield since 2018 when the Eggborough Power Station was decommissioned. Our proposals for a new datacentre will bring this former industrial site back into employment use.

Currently the site is being cleared to prepare the area for development. Our proposals represents one plot of the wider site.



Site Location & surrounds:

- Site boundary outlined in red
- 2019/1343/EIA Approval boundary in brown

Our proposals

Microsoft is proposing to develop on a portion of the former Eggborough Power Station site and deliver a new datacentre campus.

The proposals include two new datacentre buildings, including data halls, office space and further ancillary facilities, secure car parking spaces on site and landscaping improvements.

The conceptual CGI renders have been produced to illustrate how the datacentre will look upon completion.

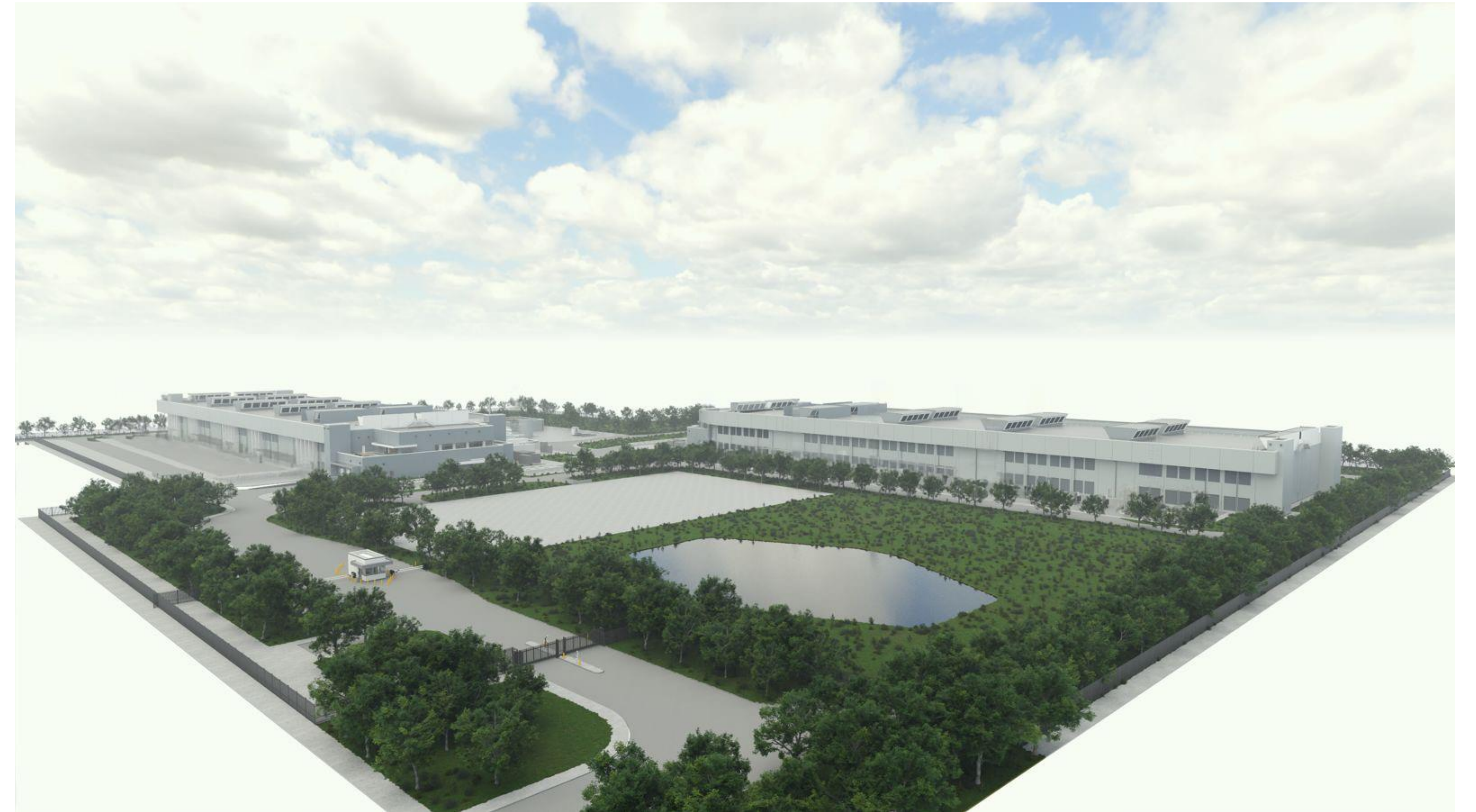

Conceptual render of the site



Render of the view from Wand Lane

Site Plan

The proposals include:

- Two datacentre buildings
- Both two-story buildings and include office and ancillary facilities
- Car and cycle parking
- Enhanced biodiversity landscaping design
- Main access from A19
- Emergency access from Wand Lane

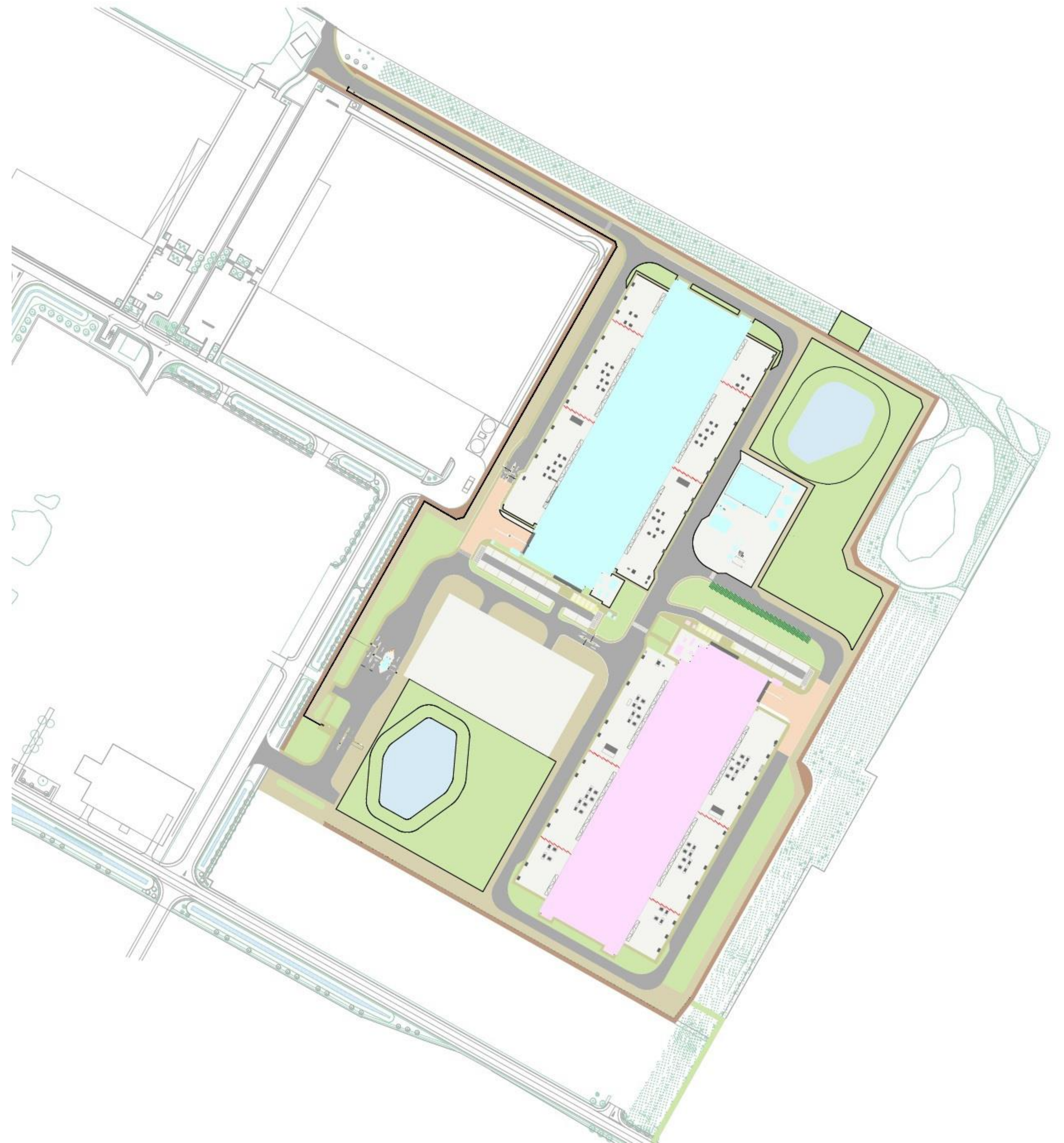

Landscaping Strategy

The proposed landscaping will prioritise biodiversity enhancement.

The planned landscaping includes:

- Grassland and wildflowers
- Wet grassland
- Woodland scrub plant edging
- Native tree planting
- Wildlife ponds



Creating jobs and supporting local businesses

Datacentres make a significant and long-term impact on the local and regional economy.

Datacentres create well-paid local and regional jobs, both during construction and operation.

Datacentre suppliers and employees support the local economy by buying local goods and services.

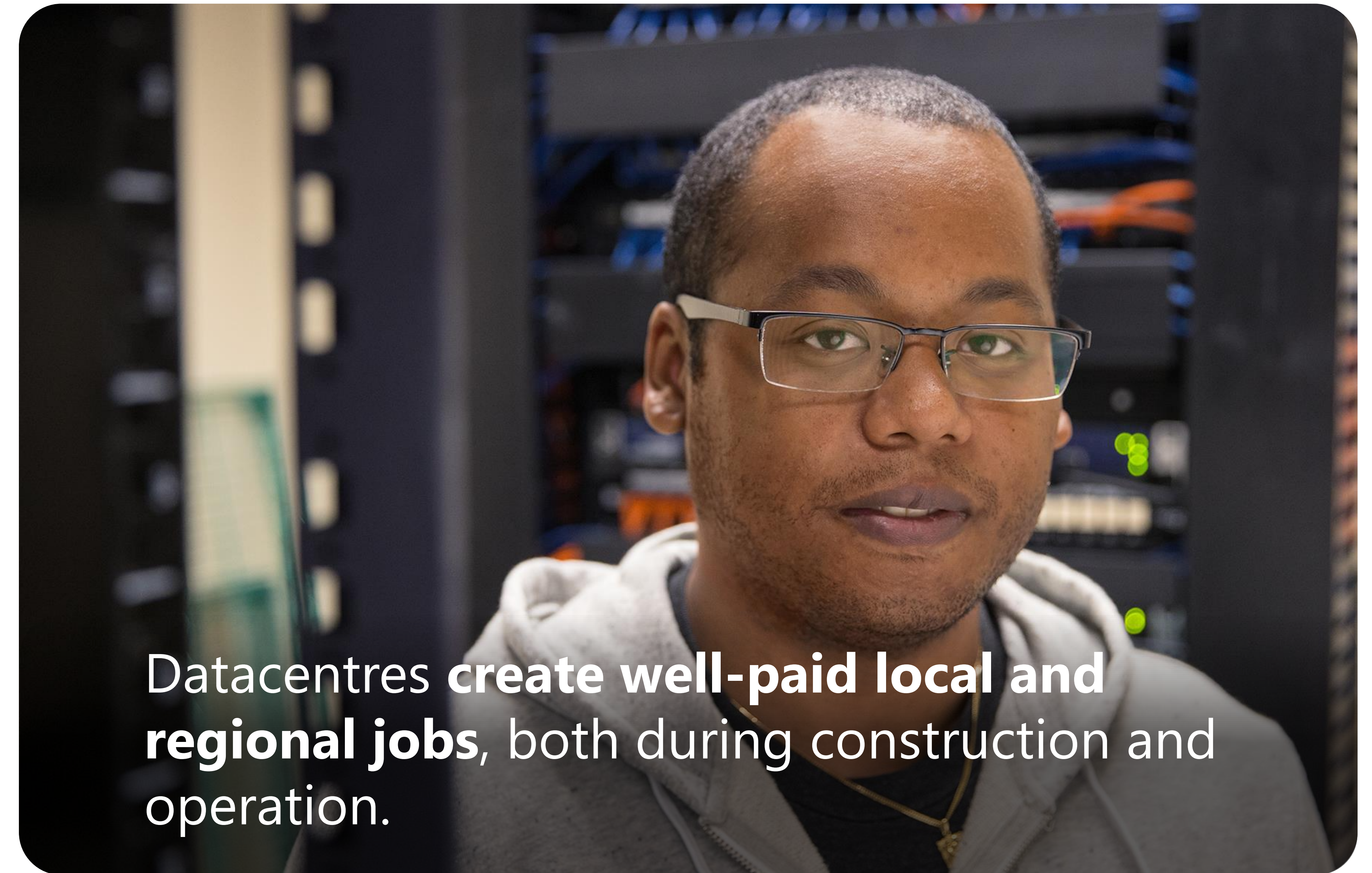

Investing in community programs and partnerships

Microsoft strives to be a good neighbour and to create a positive impact in the communities that are home to our datacentres.



Community Partnerships

Microsoft partners with a range of NGOs to support initiatives in the communities they operate.

Generation is a charity supporting people facing barriers to employment through free, profession-specific bootcamps with matchmade interview with employer partners.

Since 2021 Generation has supported 400 people in Yorkshire graduating from a range of bootcamps with 70% of participants being placed into employment with partners within the 6-month placement phase.

Microsoft has supported bootcamps focused on IT Support, Data Analytics & Cyber Security in Yorkshire.

For more information visit uk.generation.org

Generation
UNITED KINGDOM



Prioritising sustainability in our datacentres

Energy

- We've committed to have **100% renewable energy** coverage globally by **2025**
- Growing **new** renewable energy generation capacity through Power Purchase Agreements (PPAs)
- Eliminating the use of diesel for backup power by 2030



Water

- Designing datacentres to cool with outside air when possible
- **minimising water use**
- Collecting rainwater for use where feasible

Waste

- Diverting **90 percent** of datacentre operational waste by 2030
- Building Circular Centers to **reuse servers and hardware**

Next Steps

Following this consultation, we will review the feedback received and then make our submission to North Yorkshire Council.

Construction completion date does not indicate datacentre operation/availability.

Dates are indicative and subject to change and dependent on the planning process.

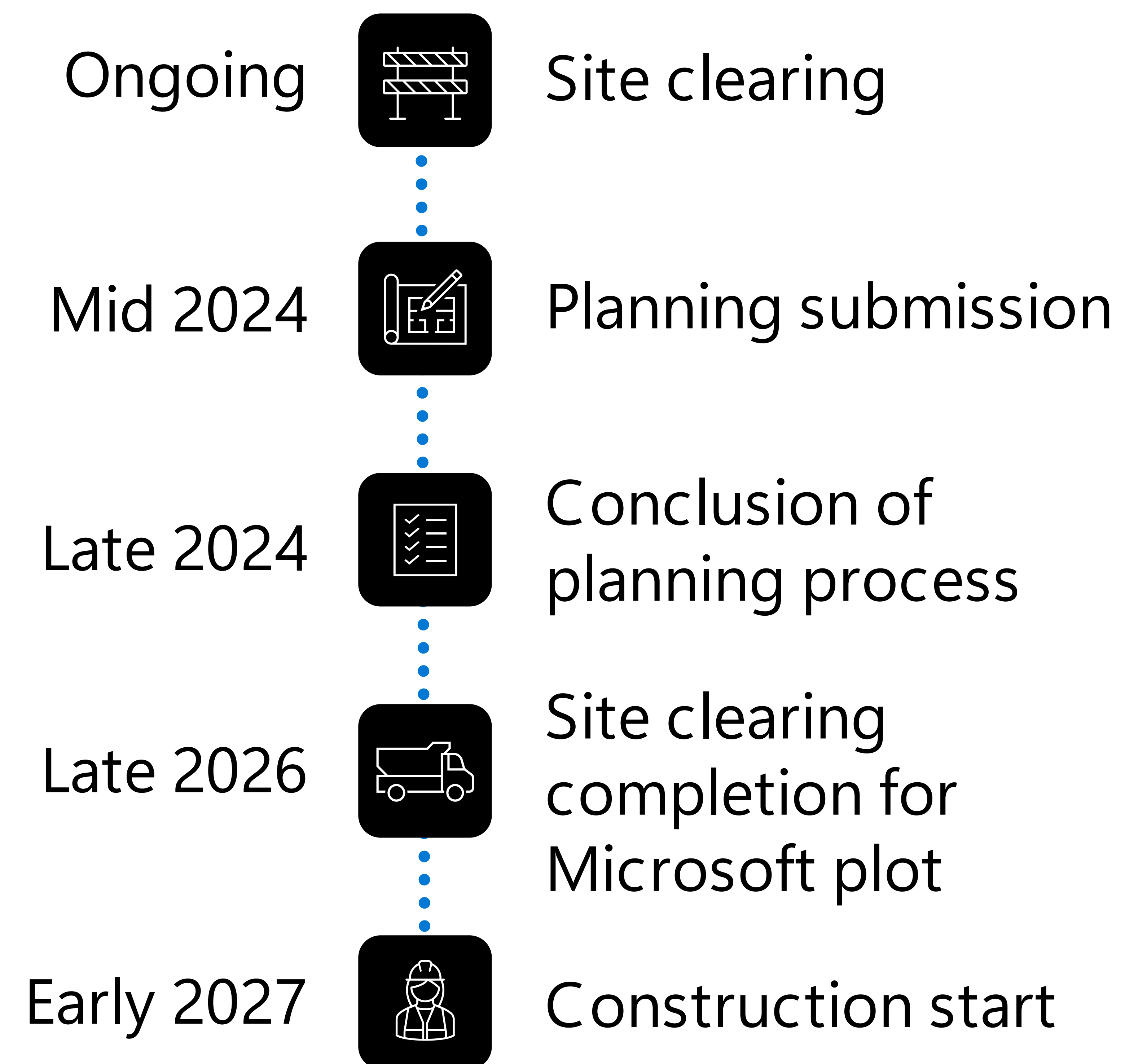

Indicative timeline

Thank you

Thank you for participating in our consultation, we hope you found it useful and informative.

Feedback

If you have any further questions or comments, please contact the Microsoft Community Affairs team.

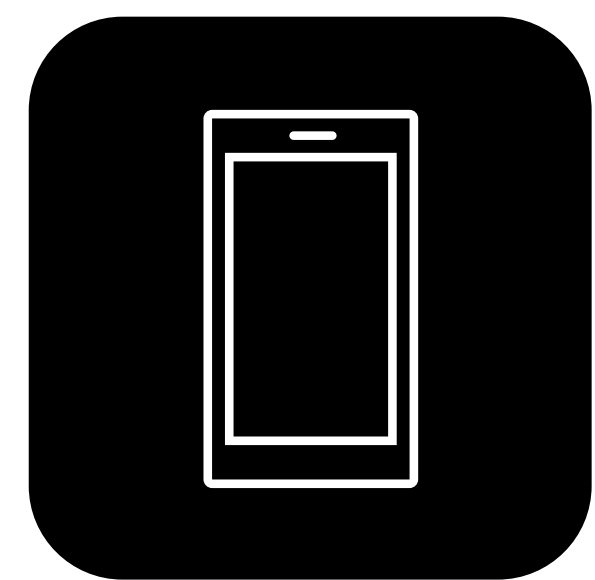

0800 915 3677

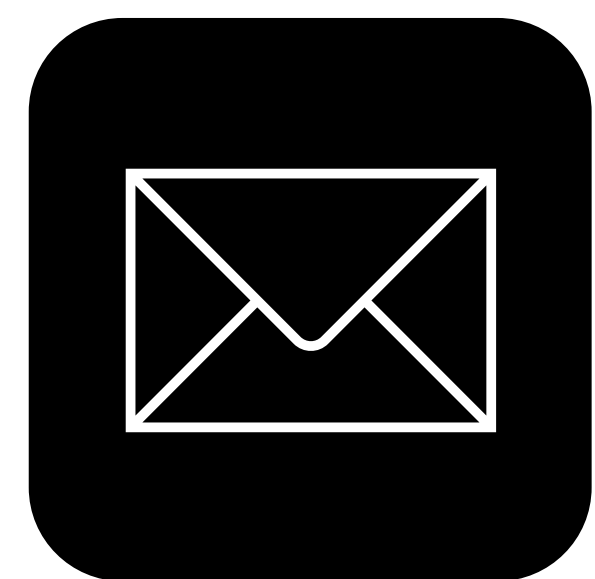

UKDC@microsoft.com

For more information on our operations in the UK, visit:

[local.microsoft.com/
communities/emea/
united-kingdom](https://local.microsoft.com/communities/emea/united-kingdom)